



FOR LEASE

Small Central Industrial Warehouse for Lease

SPACE AVAILABLE: 1,400 SF

PROPERTY HIGHLIGHTS

- Central location
- Located in Ruby Hill
- Local ownership
- Located within an Enterprise Zone
- Front park, rear load



LEASE RATE:
\$2,350.00
PER MONTH GROSS

Russell Gruber
Industrial Specialist / Owner
Cell: 720-490-1442
russell@grubercre.com

Steve Fletcher
Industrial Specialist
Cell: 720-320-0366
steve@grubercre.com

Gruber
COMMERCIAL REAL ESTATE

1221 S. LIPAN STREET

DENVER, COLORADO

Gruber Commercial Real Estate, Inc | 209 Kalamath Street #9, Denver, CO 80223 | Tel: 720-490-1442

PROPERTY DETAILS

- **Size:** 1,400/SF
- **Office:** 500/SF +/-
- **YOC:** 1986
- **LOT:** 2,500/SF
- **Zoning:** I-MX-3
- **Loading:** One drive (10'x10')
- **Clear Height:** 12'ft
- **Power:** 3 phase (to be verified)
- **Heat:** Gas forced in warehouse
- **A/C:** in office and forced air
- **Taxes (2021):** \$5,518.02

FLOOR PLAN

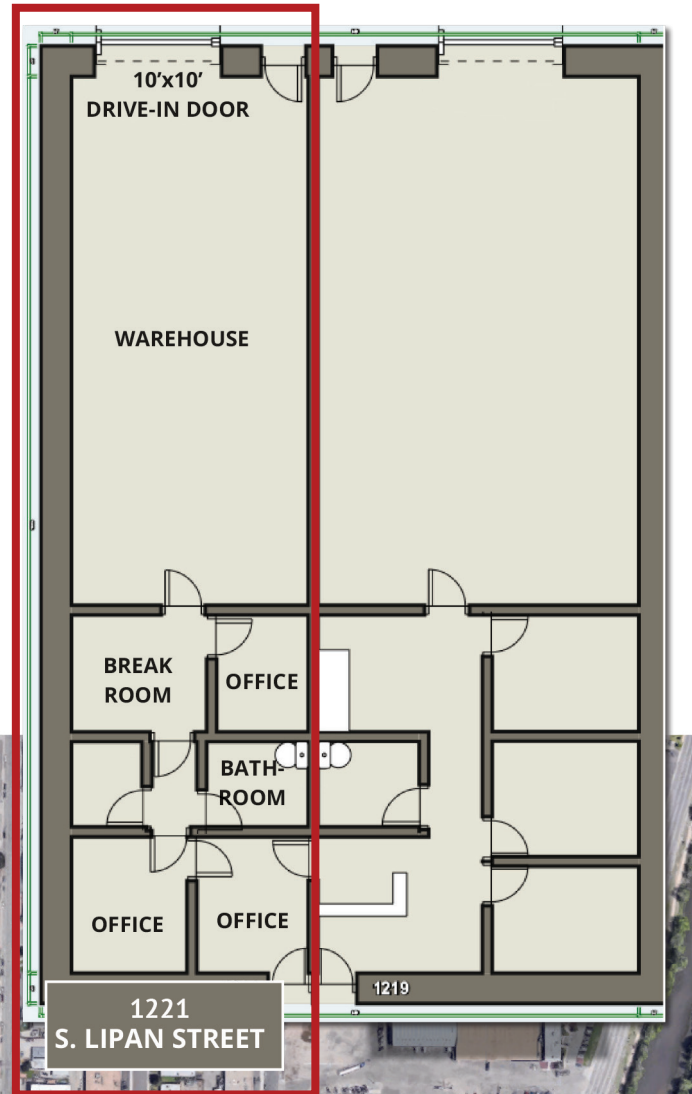

Russell Gruber
Industrial Specialist / Owner
Cell: 720-490-1442
russell@grubercre.com

Steve Fletcher
Industrial Specialist
Cell: 720-320-0366
steve@grubercre.com

Gruber
COMMERCIAL REAL ESTATE

grubercommercial.com

The information above has been obtained from sources believed reliable. While we do not doubt its accuracy, we have not verified it and make no guarantee, warranty or representation about it. It is your responsibility to independently confirm its accuracy and completeness. Any projections, opinions, assumptions or estimates used are for example only and do not represent the current or future performance of the property. The value of this transaction to you depends on tax and other factors which should be evaluated by your tax, financial and legal advisors. You and your advisors should conduct a careful, independent investigation of the property to determine to your satisfaction the suitability of the property for your needs. Gruber Commercial Real Estate Services.