

G



2677 W. Hampden Avenue, Unit B, Englewood, CO

Small Industrial Unit For Lease

FOR LEASE

PROPERTY HIGHLIGHTS

- Desirable location, easy access to Hwy 285
- Possible expansion options available within building
- Lease rates are modified gross



SPACE AVAILABLE:
1,500 SF (UNIT B)

LEASE RATE: \$2,500/MONTH MG

For More Information, Contact:

Steve Fletcher | *Industrial Specialist*
(720) 320-0366
steve@grubercre.com

SITE PLAN

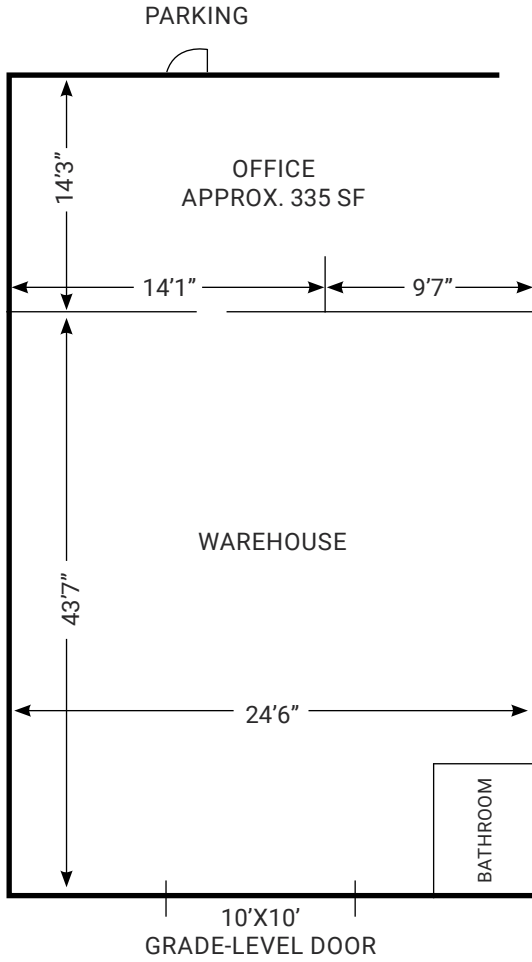

PROPERTY DETAILS

- **Space Available:** 1,500 SF (Unit B)
- **Loading:** 1 grade-level door (10'x10')
- **Building Size:** 9,000 SF
- **Clear Height:** 11'
- **YOC:** 1963
- **Zoning:** BUS-I: Business (City of Sheridan)



For More Information, Contact:

Steve Fletcher | *Industrial Specialist*
(720) 320-0366
steve@grubercre.com

