

48 EAST 56TH AVE

DENVER, CO 80216

Gruber Commercial Real Estate, Inc | 209 Kalamath Street #9, Denver, CO 80223 | 720-490-1442



FOR LEASE

High Visibility Industrial Building

BUILDING SIZE: 14,500/SF

OFFICE SIZE: 1,980/SF

**(Plus 1,500/SF Garden Level Office,
not included in square footage)**

PROPERTY HIGHLIGHTS

- Major I-25 Visibility
- Large Fenced Yard
- Easy Access to I-25 and I-70
- Fully Paved Site
- LED Lights
- Unincorporated Adams County
- Local Ownership
- Former Cross Dock Facility
(doors can be re-opened)

Russell Gruber

Industrial Specialist / Owner

720-490-1442

russell@grubercre.com

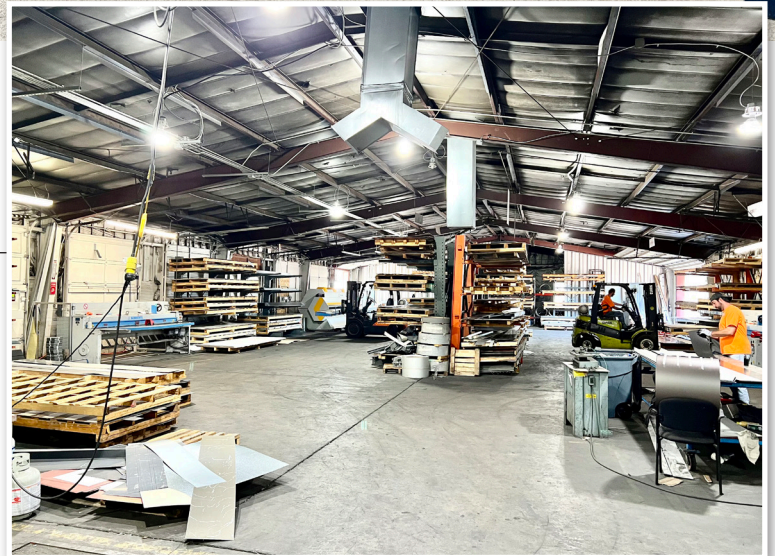

LEASE RATE
CONTACT BROKER

Gruber

COMMERCIAL REAL ESTATE

grubercommercial.com

Gruber Commercial Real Estate, Inc | 209 Kalamath Street #9, Denver, CO 80223 | 720-490-1442

PROPERTY DETAILS

- **Building Size:** 14,500/SF
- **Office Size:** 1,980/SF plus 1,500/SF Garden level office (not in square footage)
- **YOC:** 1964
- **Construction:** Metal
- **City/County:** Unincorporated Adams County
- **Loading:** Currently 8 dock high doors (2 are ramped)
 - Building has potential for 33 Dock doors
- **Columns:** Clear Span
- **Power:** 400amps, 240Volt (to be verified)
- **Clear Height:** 17' at the peak (pitched roof)
- **Heat:** Gas Forced
- **A/C:** Office only

FLOOR PLAN

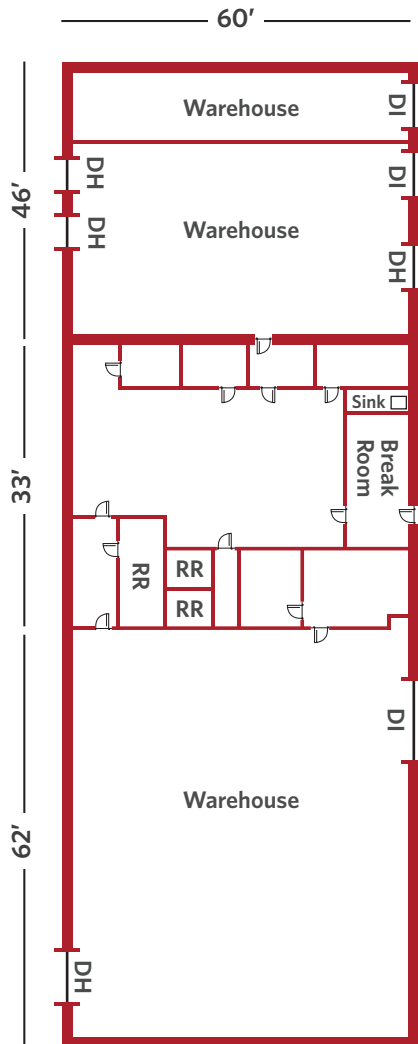

AERIAL VIEWS



Russell Gruber
Industrial Specialist / Owner
720-490-1442
russell@grubercre.com

Gruber
COMMERCIAL REAL ESTATE

grubercommercial.com

The information above has been obtained from sources believed reliable. While we do not doubt its accuracy, we have not verified it and make no guarantee, warranty or representation about it. It is your responsibility to independently confirm its accuracy and completeness. Any projections, opinions, assumptions or estimates used are for example only and do not represent the current or future performance of the property. The value of this transaction to you depends on tax and other factors which should be evaluated by your tax, financial and legal advisors. You and your advisors should conduct a careful, independent investigation of the property to determine to your satisfaction the suitability of the property for your needs. Gruber Commercial Real Estate Services.