

**5314-5350 BROADWAY**  
DENVER, COLORADO

Gruber Commercial Real Estate, Inc | 209 Kalamath Street #9, Denver, CO 80223 | Tel: 720-490-1442



**FOR SALE**

## 3,500/SF FREESTANDING WAREHOUSE WITH YARD AND SIGN ON I-25

**BUILDING SIZE: 3,500/SF**

### PROPERTY HIGHLIGHTS

- New electronic monument sign fronting on I-25
- Major I-25 visibility
- New roof in 2019
- Divisible building
- Fenced yard
- Two gas and two electric meters
- Located in Unincorporated Adams County
- Located within an enterprise zone
- Located within an Opportunity Zone
- 228,621 cars per day (Costar/2022)

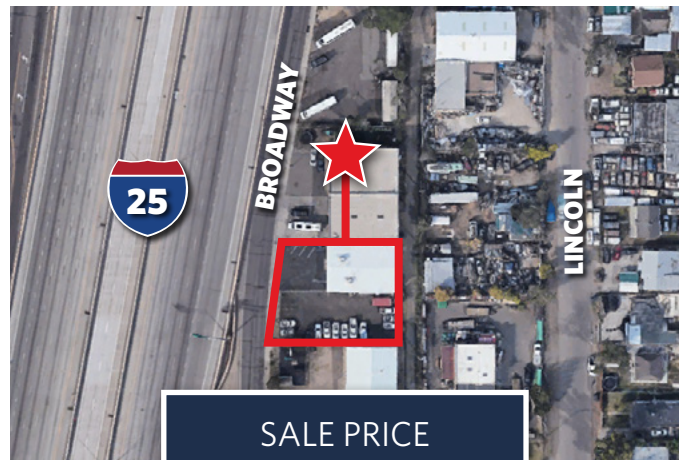

**SALE PRICE**  
**\$1,425,000.00**

**Russell Gruber**

*Industrial Specialist / Owner*

**Cell: 720-490-1442**

[russell@grubercre.com](mailto:russell@grubercre.com)

**Gruber**

COMMERCIAL REAL ESTATE

[grubercommercial.com](http://grubercommercial.com)

# 5314-5350 BROADWAY

DENVER, COLORADO

Gruber Commercial Real Estate, Inc | 209 Kalamath Street #9, Denver, CO 80223 | Tel: 720-490-1442

## PROPERTY DETAILS

- **Building Size:** 3,500/SF
- **Office:** 1,000/SF (+/-)
- **Site Size:** 13,068/SF (total)
- **Zoning:** I-1 (industrial)
- **YOC:** 1971
- **Property tax:** \$14,024.26
- **Clear Height:** 12'ft
- **Loading:** 2 dock doors
- **Power:** Two 200 amps services (3-phase)
- **Heat:** Gas forced
- **A/C:** Office areas only

## AERIAL VIEW



**Russell Gruber**  
*Industrial Specialist / Owner*  
**Cell: 720-490-1442**  
russell@grubercre.com

**Gruber**  
COMMERCIAL REAL ESTATE

grubercommercial.com

The information above has been obtained from sources believed reliable. While we do not doubt its accuracy, we have not verified it and make no guarantee, warranty or representation about it. It is your responsibility to independently confirm its accuracy and completeness. Any projections, opinions, assumptions or estimates used are for example only and do not represent the current or future performance of the property. The value of this transaction to you depends on tax and other factors which should be evaluated by your tax, financial and legal advisors. You and your advisors should conduct a careful, independent investigation of the property to determine to your satisfaction the suitability of the property for your needs. Gruber Commercial Real Estate Services.