

# 7790 S. WHEELING CT. UNIT B

ENGLEWOOD, COLORADO

Gruber Commercial Real Estate, Inc | 209 Kalamath Street #9, Denver, CO 80223 | Tel: 720-490-1442



**FOR LEASE**

## End Cap Industrial Space

**SPACE AVAILABLE: 10,400 SF**

### PROPERTY HIGHLIGHTS

- Newly paved parking lot
- Versatile loading
- ESFR Sprinkler
- End cap unit
- Glass lined office
- Only a 2 tenant building
- Local Ownership



**LEASE RATE**  
**\$12.50 NNN**

### Russell Gruber

*Industrial Specialist / Owner*

**Cell: 720-490-1442**

[russell@grubercre.com](mailto:russell@grubercre.com)

**Gruber**  
COMMERCIAL REAL ESTATE

[grubercommercial.com](http://grubercommercial.com)

# 7790 S. WHEELING CT. UNIT B

ENGLEWOOD, COLORADO

Gruber Commercial Real Estate, Inc | 209 Kalamath Street #9, Denver, CO 80223 | Tel: 720-490-1442

## PROPERTY DETAILS

- **Available space:** 10,400/sf (building is 20,800/sf)
- **Office Size:** 2,761/sf (very open)
- **Total Site Size:** 1.84 acres
- **Lease Rate:** \$12.50/sf
- **2021 Taxes:** \$4.79/sf
- **A/C:** Office Only
- **Heat:** Gas forced
- **Estimated NNN:** \$5.77/sf
- **Loading:** 1 dock high door & 1 oversized drive in door
- **Clear Height:** 18'ft
- **Power:** 3-phase, heavy power
- **Sprinkler:** Yes-ESFR
- **Column Spacing:** Only one column in warehouse

## FLOOR PLAN

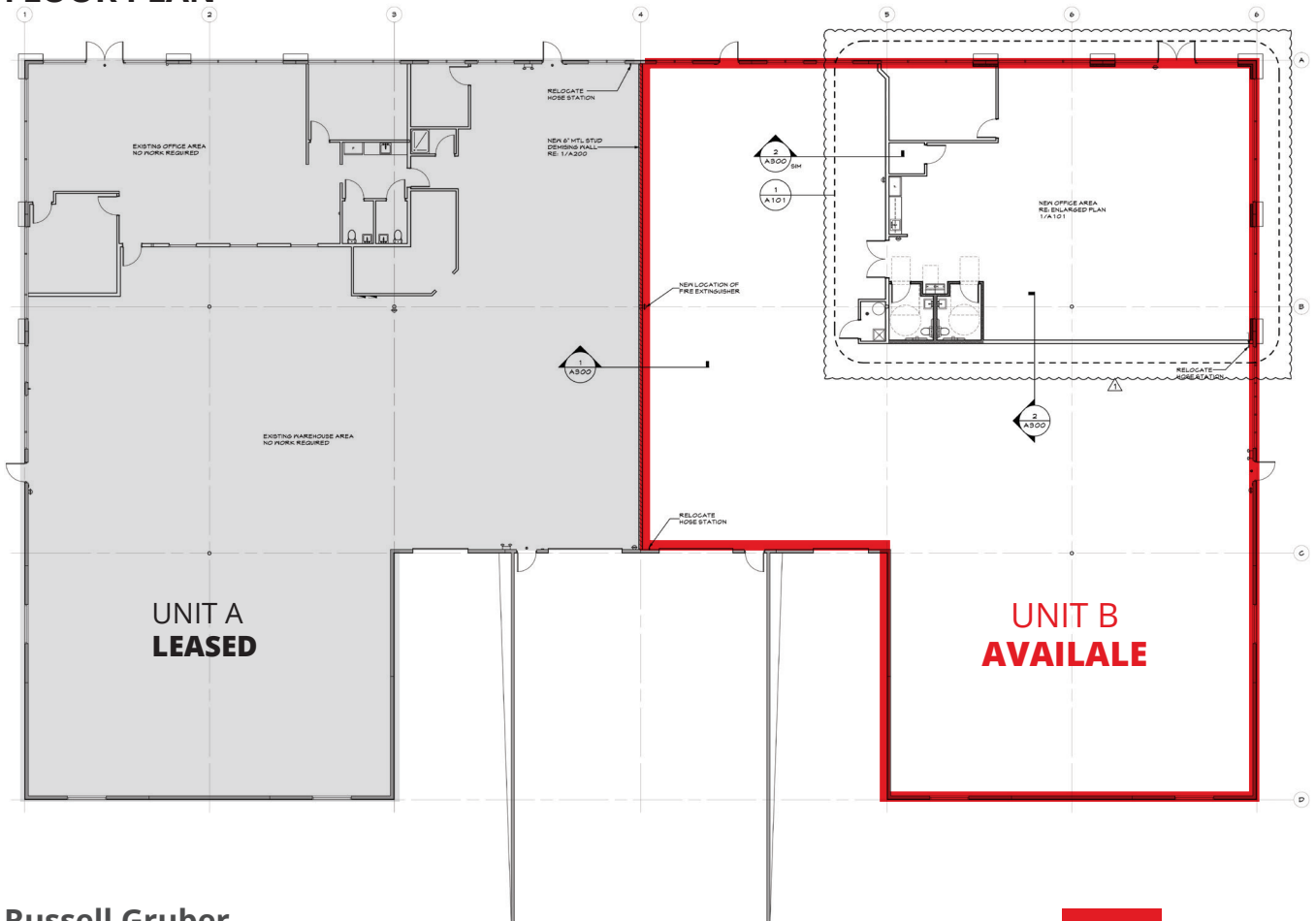

**Russell Gruber**  
Industrial Specialist / Owner  
Cell: 720-490-1442  
russell@grubercr.com

**Gruber**  
COMMERCIAL REAL ESTATE

grubercommercial.com

The information above has been obtained from sources believed reliable. While we do not doubt its accuracy, we have not verified it and make no guarantee, warranty or representation about it. It is your responsibility to independently confirm its accuracy and completeness. Any projections, opinions, assumptions or estimates used are for example only and do not represent the current or future performance of the property. The value of this transaction to you depends on tax and other factors which should be evaluated by your tax, financial and legal advisors. You and your advisors should conduct a careful, independent investigation of the property to determine to your satisfaction the suitability of the property for your needs. Gruber Commercial Real Estate Services.